



**HARTMANN ELECTRONIC**

A Phoenix Mecano Company

**4U/ 32 HP Chassis  
SERIAL**

**SERIAL**

**4 Slot Backplane, ATX 180 W**

## ***CompactPCI® Serial***

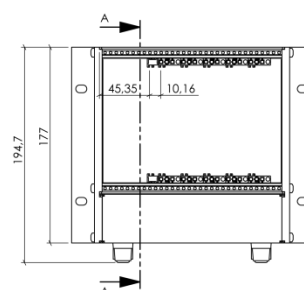

### **Key features:**

- 4U (1+3) 32 HP CompactPCI Chassis Platform
- Card rack acc. to IEEE 1101.1, 1101.10/11 and IEC 60297-3-101, -102, -103, Aluminum, for wall assembly
- CompactPCI Serial backplane: 3 U, 4 slots, system slot right, w/o rear IO, GbE Full Mesh Topology, PCIe Gen3
- ATX power supply unit 180 W with, wide range input 100 – 240 VAC , 47 - 63 Hz (3.3 V / 12 A, 5 V / 14 A, 12 V / 14 A, –12 V / 0.3 A and min. load: +12 V / 0.3 A) with PFC, with fan and switch, with cable harness for connection, to backplane, incl. 3U / 10HP front panel
- Cooled by 1x +12V DC fans 120mm, air flow from bottom to top
- Completely assembled and wired
- Other configurations on request

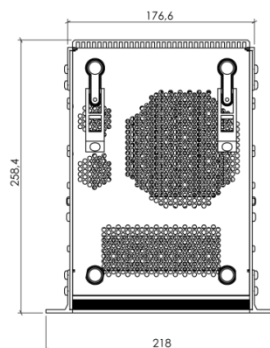

Dimensions  
B: 176.6 mm  
H: 177.0 mm  
D: 254.4 mm

Order number: **LMH0000830**

